

Consultation on Designation of Bacup and Stacksteads Neighbourhood Forum and Neighbourhood Area

Representations Received on Proposed Neighbourhood Forum and Neighbourhood Area

14th January 2020 – 25th February 2020



April 2020

Rossendale
BOROUGH COUNCIL

Contents

Summary of Representations	3
Appendix A – Individual Responses	5

Summary of Representations

- 1.1 During the six-week consultation for the proposed Neighbourhood Forum and Neighbourhood Area, a total of 32 representations were received, including 6 made by statutory bodies/organisations, and 26 individual responses submitted through the online consultation form.
- 1.2 All 26 individual responses supported the proposed designation of the Neighbourhood Forum, while the six statutory bodies/organisations submitted neutral representations. One objection was received through the online consultation form, but this was anonymised and therefore could not be recorded. One respondent submitted two individual representations through the online form and these have been recorded as one submission respectively.
- 1.3 Regarding the designation of the Neighbourhood Area, six neutral comments were received and there were also 25 responses in support of the proposed area and one objection. The objection stated that the settlement of Weir should be included within the Neighbourhood Area.
- 1.4 Despite all individual responses supporting the designation of a Neighbourhood Forum for Bacup and Stacksteads, certain respondents also raised concerns. The following below provides a summary of the individual responses and separates them into positive and negative representations:

Positive Comments
<ul style="list-style-type: none">• Provide the people of Bacup with an alternative voice;• Provide a platform for everyone to have their voices heard, opinions considered, and ideas shared;• Help re-engage the community and increase public involvement in decision making and planning in general;• Allow local residents to work alongside the Council and improve the area;• Members comprising the Forum are knowledgeable residents;• Constitution states all members of the community can be involved;• The proposed boundary includes all parts of Bacup and Stacksteads; and

- Forum supported by a strong vision and understanding of what's required from Neighbourhood Planning process.

Concerns Raised

- Lack of information regarding the Forum's governance and membership composition;
- Difficult to determine whether the Forum is representative of the community;
- Greater publicity of the Forum would have given a fairer representation across the community;
- Questions raised over whether 21 members is enough and should these members be independent from local councillors;
- The Neighbourhood Area should include Weir; and
- Method of consultation not adequate to achieve true representation of local population.

1.5 The individual representations received are shown in Appendix A, and this includes the anonymised objection which has not been recorded in the total figures.

Appendix A – Individual Representations

Organisations

Natural England	1
Lancashire Wildlife Trust	6
Historic England	10
Gladman Developments Ltd.....	12
Homes England.....	16
The Coal Authority.....	17

Online Forms

Alex Buchan	19
Mark McGovern.....	21
Phill Rawlins	23
Edith Challinor	25
Alan Boon.....	27
Janet Boon (submitted additional online comment see page 73)	29
Edith Freeman.....	31
Victoria Burnside	33
Rachel Shipley	35
Paul Talbot	37
vv vv	39
Stephen Anderson.....	41
Jennifer Rawlins (submitted additional online comment see page 59)	43
Nicola Longmire	45
Duncan Middlebrook	47
Karen Dodson	49

Anita Heyworth	51
Elizabeth Wright	53
Andrea Harwood	55
Ian Francis	57
Jennie Rawlins (submitted additional online comment see page 43)	59
Daniel Dawkins	61
Sandra Harrow	63
Gary Catlow	65
June Griffin	67
Keith Loughlin	69
Robert Wells.....	71
Janet Boon (submitted additional online comment see page 29)	73

Date: 15 January 2020
Our ref: [REDACTED]



Rossendale Borough Council
[REDACTED]

Hornbeam House
Crewe Business Park
Electra Way
Crewe
Cheshire
CW1 6GJ

BY EMAIL ONLY

T 0300 [REDACTED]

Dear Sir/Madam

Consultation on the designation of Bacup and Stacksteads Neighbourhood Forum and Neighbourhood Area

Thank you for your email dated 14/01/2020 notifying Natural England of the above Neighbourhood Planning Area

Natural England does not wish to make comment on the suitability of the proposed plan area or the proposed neighbourhood planning body.

However we would like to take this opportunity to provide you with information sources the neighbourhood planning body may wish to use in developing the plan, and to highlight some of the potential environmental risks and opportunities that neighbourhood plans may present. We have set this out in the annex to this letter.

Natural England's role

Natural England is a non-departmental public body. Our statutory purpose is to ensure that the natural environment is conserved, enhanced, and managed for the benefit of present and future generations, thereby contributing to sustainable development. The local planning authority will be aware and should advise the neighbourhood planning body when Natural England should be consulted further on the neighbourhood plan.

Planning policy for the natural environment

Neighbourhood plans and orders present significant opportunities, but also potential risks, for the natural environment. Proposals should be in line with the National Planning Policy Framework. The key principles are set out in paragraphs 170-177.

The planning system should contribute to and enhance the natural and local environment by:

- protecting and enhancing valued landscapes, geological conservation interests and soils;
- recognising the wider benefits of ecosystem services;
- minimising impacts on biodiversity and providing net gains in biodiversity where possible, contributing to the Government's commitment to halt the overall decline in biodiversity, including by establishing coherent ecological networks that are more resilient to current and future pressures;

The neighbourhood planning body should also consider the natural environment policies in the area's Local Plan. The neighbourhood plan or order should be consistent with these, and the neighbourhood planning body may decide that the emerging Neighbourhood Plan should provide more detail as to how some of these policies apply or are interpreted locally.

The attached annex sets out sources of environmental information and some natural environment issues you may wish to consider as the neighbourhood plan or order is developed.

Yours faithfully

Matthew Dean
Consultations Team

Annex 1 - Neighbourhood planning and the natural environment: information, issues and opportunities

Natural environment information sources

The [Magic](http://magic.defra.gov.uk/)¹ website will provide you with much of the nationally held natural environment data for your plan area. The most relevant layers for you to consider are: **Agricultural Land Classification, Ancient Woodland, Areas of Outstanding Natural Beauty, Local Nature Reserves, National Parks (England), National Trails, Priority Habitat Inventory, public rights of way (on the Ordnance Survey base map) and Sites of Special Scientific Interest (including their impact risk zones)**. Local environmental record centres may hold a range of additional information on the natural environment. A list of local record centres is available [here](#)².

Priority habitats are those habitats of particular importance for nature conservation, and the list of them can be found [here](#)³. Most of these will be mapped either as **Sites of Special Scientific Interest**, on the Magic website or as **Local Wildlife Sites**. Your local planning authority should be able to supply you with the locations of Local Wildlife Sites.

National Character Areas (NCAs) divide England into 159 distinct natural areas. Each character area is defined by a unique combination of landscape, biodiversity, geodiversity and cultural and economic activity. NCA profiles contain descriptions of the area and statements of environmental opportunity, which may be useful to inform proposals in your plan. NCA information can be found [here](#)⁴.

There may also be a local **landscape character assessment** covering your area. This is a tool to help understand the character and local distinctiveness of the landscape and identify the features that give it a sense of place. It can help to inform, plan and manage change in the area. Your local planning authority should be able to help you access these if you can't find them online.

If your neighbourhood planning area is within or adjacent to a **National Park** or **Area of Outstanding Natural Beauty (AONB)**, the relevant National Park/AONB Management Plan for the area will set out useful information about the protected landscape. You can access the plans on from the relevant National Park Authority or Area of Outstanding Natural Beauty website.

General mapped information on **soil types** and **Agricultural Land Classification** is available (under 'landscape') on the [Magic](http://magic.defra.gov.uk/)⁵ website and also from the [LandIS website](http://www.landis.org.uk/index.cfm)⁶, which contains more information about obtaining soil data.

Natural environment issues to consider

The [National Planning Policy Framework](https://www.gov.uk/government/publications/national-planning-policy-framework--2)⁷ sets out national planning policy on protecting and enhancing the natural environment. [Planning Practice Guidance](http://planningguidance.planningportal.gov.uk/blog/guidance/natural-environment/)⁸ sets out supporting guidance.

Your local planning authority should be able to provide you with further advice on the potential impacts of your plan or order on the natural environment and the need for any environmental assessments.

¹ <http://magic.defra.gov.uk/>

² <http://www.nbn-nfbr.org.uk/nfbr.php>

³ <http://webarchive.nationalarchives.gov.uk/https://www.naturalengland.org.uk/ourwork/conservation/biodiversity/protectandmanage/habsandspeciesimportance.aspx>

⁴ <https://www.gov.uk/government/publications/national-character-area-profiles-data-for-local-decision-making>

⁵ <http://magic.defra.gov.uk/>

⁶ <http://www.landis.org.uk/index.cfm>

⁷ <https://www.gov.uk/government/publications/national-planning-policy-framework--2>

⁸ <http://planningguidance.planningportal.gov.uk/blog/guidance/natural-environment/>

Landscape

Your plans or orders may present opportunities to protect and enhance locally valued landscapes. You may want to consider identifying distinctive local landscape features or characteristics such as ponds, woodland or dry stone walls and think about how any new development proposals can respect and enhance local landscape character and distinctiveness.

If you are proposing development within or close to a protected landscape (National Park or Area of Outstanding Natural Beauty) or other sensitive location, we recommend that you carry out a landscape assessment of the proposal. Landscape assessments can help you to choose the most appropriate sites for development and help to avoid or minimise impacts of development on the landscape through careful siting, design and landscaping.

Wildlife habitats

Some proposals can have adverse impacts on designated wildlife sites or other priority habitats (listed [here](#)⁹), such as Sites of Special Scientific Interest or [Ancient woodland](#)¹⁰. If there are likely to be any adverse impacts you'll need to think about how such impacts can be avoided, mitigated or, as a last resort, compensated for.

Priority and protected species

You'll also want to consider whether any proposals might affect priority species (listed [here](#)¹¹) or protected species. To help you do this, Natural England has produced advice [here](#)¹² to help understand the impact of particular developments on protected species.

Best and Most Versatile Agricultural Land

Soil is a finite resource that fulfils many important functions and services for society. It is a growing medium for food, timber and other crops, a store for carbon and water, a reservoir of biodiversity and a buffer against pollution. If you are proposing development, you should seek to use areas of poorer quality agricultural land in preference to that of a higher quality in line with National Planning Policy Framework para 112. For more information, see our publication [Agricultural Land Classification: protecting the best and most versatile agricultural land](#)¹³.

Improving your natural environment

Your plan or order can offer exciting opportunities to enhance your local environment. If you are setting out policies on new development or proposing sites for development, you may wish to consider identifying what environmental features you want to be retained or enhanced or new features you would like to see created as part of any new development. Examples might include:

- Providing a new footpath through the new development to link into existing rights of way.
- Restoring a neglected hedgerow.
- Creating a new pond as an attractive feature on the site.
- Planting trees characteristic to the local area to make a positive contribution to the local landscape.
- Using native plants in landscaping schemes for better nectar and seed sources for bees and birds.
- Incorporating swift boxes or bat boxes into the design of new buildings.
- Think about how lighting can be best managed to encourage wildlife.
- Adding a green roof to new buildings.

⁹<http://webarchive.nationalarchives.gov.uk/https://www.naturalengland.org.uk/ourwork/conservation/biodiversity/protectandmanage/habsandspeciesimportance.aspx>

¹⁰ <https://www.gov.uk/guidance/ancient-woodland-and-veteran-trees-protection-surveys-licences>

¹¹ <http://webarchive.nationalarchives.gov.uk/https://www.naturalengland.org.uk/ourwork/conservation/biodiversity/protectandmanage/habsandspeciesimportance.aspx>

¹² <https://www.gov.uk/protected-species-and-sites-how-to-review-planning-proposals>

¹³ <http://publications.naturalengland.org.uk/publication/35012>

You may also want to consider enhancing your local area in other ways, for example by:

- Setting out in your plan how you would like to implement elements of a wider Green Infrastructure Strategy (if one exists) in your community.
- Assessing needs for accessible greenspace and setting out proposals to address any deficiencies or enhance provision.
- Identifying green areas of particular importance for special protection through Local Green Space designation (see [Planning Practice Guidance on this](http://planningguidance.planningportal.gov.uk/blog/guidance/open-space-sports-and-recreation-facilities-public-rights-of-way-and-local-green-space/local-green-space-designation/) ¹⁴).
- Managing existing (and new) public spaces to be more wildlife friendly (e.g. by sowing wild flower strips in less used parts of parks, changing hedge cutting timings and frequency).
- Planting additional street trees.
- Identifying any improvements to the existing public right of way network, e.g. cutting back hedges, improving the surface, clearing litter or installing kissing gates) or extending the network to create missing links.
- Restoring neglected environmental features (e.g. coppicing a prominent hedge that is in poor condition, or clearing away an eyesore).

¹⁴ <http://planningguidance.planningportal.gov.uk/blog/guidance/open-space-sports-and-recreation-facilities-public-rights-of-way-and-local-green-space/local-green-space-designation/>

From: John Lamb [REDACTED]
Sent: 24 January 2020 15:26
To: Forward Planning
Subject: Bacup and Stacksteads Neighbourhood Area and proposed Neighbourhood Development Plan – Consultation January 2020. Comments from the Lancashire Wildlife Trust.

Dear Planning Manager,

Re: Bacup and Stacksteads Neighbourhood Area and proposed Neighbourhood Development Plan – Consultation January 2020. Comments from the Lancashire Wildlife Trust.

I am writing on behalf of the Lancashire Wildlife Trust with the following comments that relate to wildlife sites (statutory and non-statutory), notable habitats, notable species, ecological networks and net gains in the Bacup and Stacksteads Neighbourhood Forum Area.

The Wildlife Trust understands that the Neighbourhood Plan will need to conform to the policies in the Rossendale Local Plan, and hopes that the Neighbourhood Plan will add further detail and be more proactive.

The Natural Environment and Rural Communities (NERC) Act 2006 places a duty on all statutory authorities, including Borough and Parish Councils, to have due regard to biodiversity in the exercising of all of their functions. This means that both the Borough of Pendle and Barrowford Parish Council have a 'Biodiversity Duty' to conserve and enhance sites of importance for biodiversity through the preparation and implementation of the Neighbourhood Plan.

The NPPF requires there to be net gains in the environment/biodiversity/nature, which can apply to a) Sites, b) Habitats of importance, c) Species of importance, and d) ecological networks, where applicable.

- a) Sites.** Sites in the Bacup and Stacksteads Neighbourhood Forum Area must include both statutorily designated sites (Sites of Special Scientific Interest) and non-statutorily designated sites (Local Sites of biological and/or geological importance). See Note below.
- b) Habitats.** The Bacup and Stacksteads Neighbourhood Forum Area supports a variety of habitat types including semi-natural broadleaved woodland; plantation woodland; hedgerows; acidic, neutral and marshy grassland; amenity grassland; improved grassland; standing water (lodes, reservoirs and ponds); running water; and built-up land (commercial/industrial and residential).

Some of the habitat types in the Bacup and Stacksteads Neighbourhood Forum Area are Habitats of Principal Importance in England, as listed in Section 41 of the Natural Environment and Rural Communities Act (NERC) 2006, which includes the following:

- Blanket bog
- Lowland meadow
- Lowland mixed deciduous woodland
- Rivers
- Upland heathland

The Biodiversity Duty referred to in the third paragraph on page 1 also applies to the habitats listed above. See Note below.

- c) **Species.** There are records of protected and notable species in the Bacup and Stacksteads Neighbourhood Forum Area, including species covered by planning legislation and Species of Principal Importance in England, as listed in Section 41 of the NERC Act (2006).

The Biodiversity Duty referred to in the third paragraph on page 1, and in the habitats above, also applies to species. See Note below.

- d) **Ecological networks.** Paragraph/requirement 170 of the National Planning Policy Framework (NPPF) (2012, as amended) states that *“Planning policies and decisions should contribute to and enhance the natural and local environment by:*

protecting and enhancing valued landscapes, sites of biodiversity or geological value and soils (in a manner commensurate with their statutory status or identified quality in the development plan);

minimising impacts on and providing net gains for biodiversity, including by establishing coherent ecological networks that are more resilient to current and future pressures”

Paragraph/requirement 170 also states that *“Planning policies and decisions should contribute to and enhance the natural and local environment by:*

minimising impacts on and providing net gains for biodiversity, including by establishing coherent ecological networks that are more resilient to current and future pressures;”

Paragraph/requirement 171 states that plan should *“take a strategic approach to maintaining and enhancing networks of habitats and green infrastructure;”*

Furthermore, paragraph/requirement 174 states that *“To protect and enhance biodiversity and geodiversity, plans should: a) Identify, map and safeguard components of local wildlife-rich habitats and wider ecological network..., and b) promote the conservation, restoration and enhancement of priority habitats, ecological networks...”*

The Lancashire Local Nature Partnership (funded by Natural England) commissioned the Lancashire Environment Record Network (LERN) and Lancashire Wildlife Trust to produce ecological network habitat maps for the county. LERN has produced ecological network habitat maps for grassland and woodland, which are available at the District, Parish and other levels. A wetland and heathland ecological network is still in preparation.

The Neighbourhood Development Plan should take account of the ecological networks in the Bacup and Stacksteads Neighbourhood Forum Area, discuss the conservation of the components and/or identify opportunities for restoration and enhancement of the ecological networks and their functionality within and adjacent to the Forum’s Area boundary, see figure below as an example. See Note below.

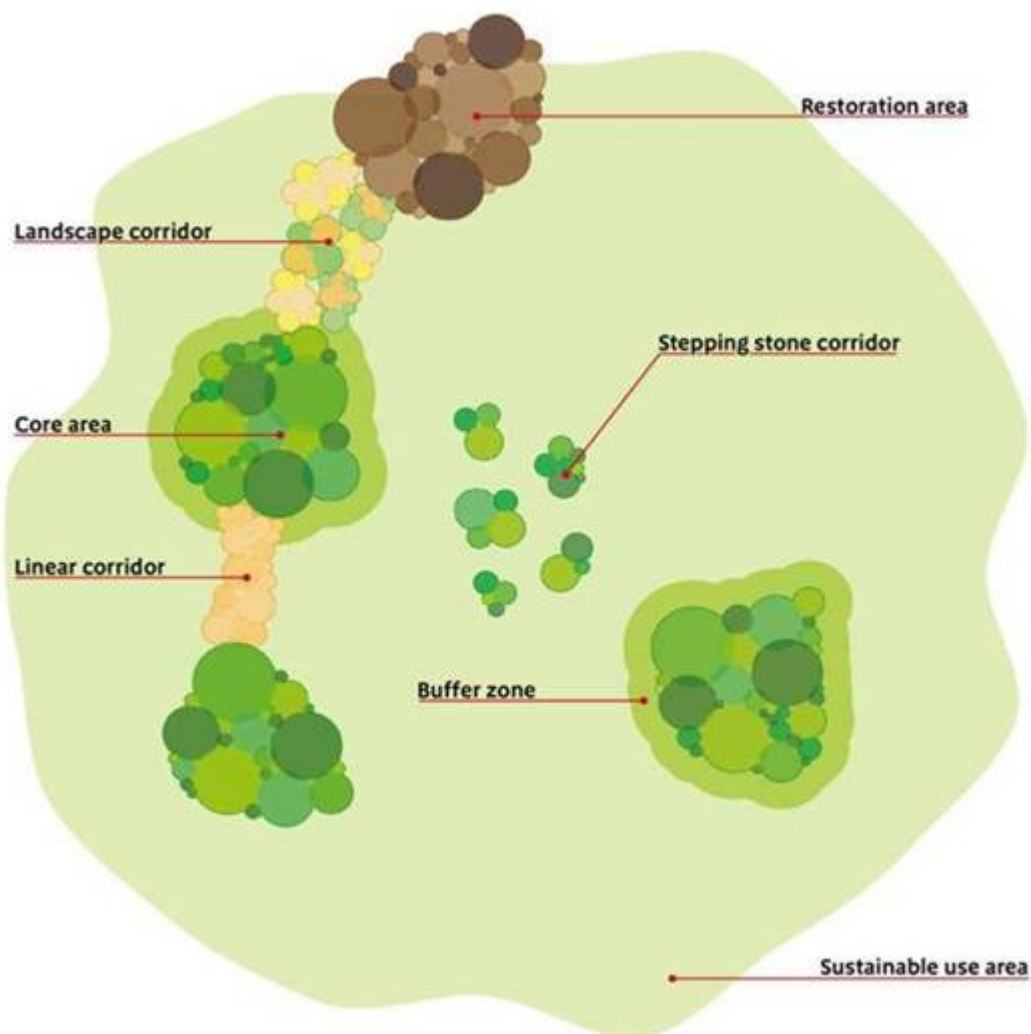

Figure from the 'Lawton Review' (2010) Making Space for Nature: a review of England's wildlife sites and ecological network. Report to Defra.

Note: Information on sites, habitats, species and ecological networks may be provided free of charge to the Neighbourhood Forum if the Borough Council has signed up to the Memorandum of Agreement with the Lancashire Environment Record Network (LERN).

Re: Net gains. Paragraph/requirement 8, 32, 170(d), 174(b) and 175(d) of the NPPF requires the planning process to deliver net gains in the environment/biodiversity/nature. This could be achieved in a number of ways, for example:

- When planning applications are approved, the Council can require the applicant to submit a Site Management Plan and a fully costed action plan lasting a minimum of five years, or for the duration of temporary developments such as wind farms and solar farms. The applicant can be required to dedicate a commuted sum, e.g. through a Section 106 agreement, in order to deliver the Site Management Plan.
- Biodiversity Offsetting. Biodiversity offsets are conservation activities that are designed to give biodiversity benefits to compensate for losses - ensuring that when a development damages nature (and this damage cannot be avoided) new, bigger or better nature sites will be created. They are different from other types of ecological compensation as they need to show measurable outcomes that are sustained over time. (see <https://www.gov.uk/guidance/biodiversity-offsetting>).
- Through the Community Infrastructure Levy (CIL).

I trust that these comments from the Wildlife Trust will be taken fully into account.

I would be grateful if you would keep me informed as to the outcome of this plan process.

Yours sincerely,

[REDACTED]

John Lamb [B.Sc.](#) (Hons.), [M.Sc.](#), MCIEEM
Senior Conservation Officer (Lancashire)

The Wildlife Trust for Lancashire, Manchester & N. Merseyside
The Barn, Berkeley Drive, Bamber Bridge, Preston. Lancs. PR5 6BY
Tel: [REDACTED] Fax: [REDACTED] www.lancswt.org.uk

mailto:[REDACTED]

direct dial & voicemail: [REDACTED]

file ref: john\plan\PE\B&S NDP2020



Historic England

NORTH WEST

Forward Planning,
Rossendale Borough Council,
Futures Park,
Bacup,
OL13 0BB

Our ref: PL00670129
Your ref:

Telephone
Mobile



6 February 2020

Dear Sir or Madam,
**Bacup and Stacksteads Neighbourhood Plan
Area Designation Consultation**

Thank you for notifying Historic England of the application by the Backup and Stacksteads Neighbourhood Forum for designation as a Neighbourhood Area under the Neighbourhood Planning (General) Regulations 2012 to enable them to undertake a Neighbourhood Development Plan.

The Backup and Stacksteads Neighbourhood Plan Area includes 2 grade II* and 59 grade II Listed Buildings, of which 1 - the Church of St Saviour - is on the Heritage at Risk Register. It also includes the Bacup Town Centre Conservation Area, which is also on the Heritage at Risk Register. It will also contain a number of locally important buildings, structures and sites (known as non-designated heritage assets). It will be important that the strategy that the Neighbourhood Forum puts together for this area safeguards those elements which contribute to the importance of those historic assets. This will assist in ensuring that they are enjoyed by those who will live or work in and visit the area in the future and make sure it is in line with national planning policy.

The Conservation Officers at Rossendale Council are the best placed people to assist Backup and Stacksteads Neighbourhood Forum in the development of the Neighbourhood Plan. They can help the Neighbourhood Forum to consider how the strategy might address the area's heritage assets.

We would also recommend that Backup and Stacksteads Neighbourhood Forum speak to the staff at the [Lancashire County Council Historic Environment Record](#) who look after the Historic Environment Record and give advice on archaeological matters. They should be able to provide details of not only any designated heritage assets but also locally-important buildings, archaeological remains and landscapes. Some Historic Environment Records may also be available on-line via the Heritage Gateway (www.heritagegateway.org.uk).



Historic England, Suite 3.3, Canada House, 3 Chepstow Street, Manchester M1 5FW
Telephone 0161 242 1416 HistoricEngland.org.uk

Please note that Historic England operates an access to information policy.
Correspondence or information which you send us may therefore become publicly available.



It may also be useful to involve local voluntary groups such as the local Civic Society, local history groups, building preservation trusts, etc. in the production of the Neighbourhood Plan.

Rossendale Council should also be able to provide general support in the production of the Backup and Stacksteads Neighbourhood Plan. National Planning Practice Guidance is clear that where it is relevant, Neighbourhood Plans need to include enough information about local heritage to guide planning decisions and to put broader strategic heritage policies from the local authority's local plan into action at a neighbourhood scale. If appropriate this should include enough information about local non-designated heritage assets including sites of archaeological interest to guide decisions.

We have produced further information and guidance on how heritage can best be incorporated into Neighbourhood Plans. This signposts a number of other documents which the Backup and Stacksteads Neighbourhood Forum might find useful in helping to identify what it is about the area which makes it distinctive and how it might go about ensuring that the character of the area is retained. These can be found at:-

<http://www.historicengland.org.uk/advice/planning/plan-making/improve-your-neighbourhood/>

If there are any queries about this matter or further discussions are needed, please do not hesitate to contact me.

It would be helpful if a copy of this letter was forwarded to the Backup and Stacksteads Neighbourhood Forum, for their information, and I hope you will be able to assist with this request.

Yours sincerely

[Redacted signature]

Craig Broadwith
Historic Places Adviser
E-mail: [Redacted email address]

By email only to: forwardplanning@rossendalebc.gov.uk

07/02/20

Re: Bacup and Stacksteads Neighbourhood Area - Regulation 6 consultation

Dear Sir/Madam,

This letter provides the response of Gladman on the application made by Bacup and Stacksteads Neighbourhood Forum for the designation of a neighbourhood area, for the purposes of preparing a neighbourhood development plan.

As this is the first formal stage of preparing a neighbourhood plan, Gladman would like to take this opportunity to comment on the Bacup and Stacksteads Neighbourhood Area application to highlight a number of key requirements to which the development of the emerging neighbourhood area should have regard to.

Gladman wish to participate in the neighbourhood plan's preparation and to be notified of further developments and consultations in this regard and request to be added to the consultation database. We would also like to offer our assistance in the preparation of neighbourhood plan and invite the Steering Group to contact us in this regard.

Legal requirements

Before a neighbourhood plan can proceed to referendum it must be tested against a set of Neighbourhood Plan Basic Conditions as set out in paragraph 8(2) of Schedule 4B of the Town and Country Planning Act 1990 (as amended by section 28a of the Planning and Compulsory Purchase Act 2004). The Basic Conditions which the Neighbourhood Plan must be found in compliance with are as follows: -

- a) Having regard to national policies and advice contained in guidance issued by the Secretary of State it is appropriate to make the neighbourhood plan;*
- b) Having special regard to the desirability of preserving any listed building or its setting or any features of special architectural or historic interest that it possesses, it is appropriate to make the order;*
- c) Having regard to the desirability of preserving or enhancing the character or appearance of any conservation area, it is appropriate to make the order;*
- d) The making of the neighbourhood plan contributes to the achievement of sustainable development;*
- e) The making of the neighbourhood plan is in general conformity with the strategic policies contained within the development plan for the area of the authority; and*
- f) The making of the neighbourhood plan does not breach, and is otherwise compatible with, EU obligations.*
- g) The making of the neighbourhood plan does not breach the requirements of Chapter 8 of the Conservation of Habitats and Species Regulations 2017.*

Through the preparation of the Neighbourhood Plan it is important for the Steering Group to ensure that the policies contained in the Plan are in accordance with the Basic Conditions as set out above. If regard has not been given to the

basic conditions through the drafting of policies that are to be contained in the neighbourhood plan then there is a real risk that the policies will be found inconsistent with the basic conditions when it reaches independent examination and may be unable to proceed to referendum.

National Planning Policy Framework

The National Planning Policy Framework (the Framework) sets out the Government's planning policies for England and how these are expected to be applied. In doing so it sets out the requirements of the preparation of Neighbourhood Plans within which locally-prepared plans for housing and other development can be produced.

In 2018, the Minister of Housing, Communities & Local Government (MHCLG) introduced the first changes to the Framework (the Revised Framework) which has since brought about fundamental changes to the planning system, with further changes made in February 2019. Indeed, paragraph 13 of the Revised Framework clearly states:

"The application of the presumption has implications for the way communities engage in neighbourhood planning. Neighbourhood plans should support the delivery of strategic policies contained in local plans or spatial development strategies; and should shape and direct development that is outside of these strategic policies."

The Revised Framework also provides further clarification on the Written Ministerial Statement. Paragraph 14 states that:

"In situations where the presumption (at paragraph 11d) applies to applications involving the provision of housing, the adverse impact of allowing development that conflicts with the neighbourhood plan is likely to significantly and demonstrably outweigh the benefits, provided all of the following apply:

- a. The neighbourhood plan became part of the development plan two years or less before the date on which the decision is made;*
- b. The neighbourhood plan contains policies and allocations to meet its identified housing requirement;*
- c. The local planning authority has at least a three-year supply of deliverable housing sites (against its five-year housing supply requirement, including the appropriate buffer as set out in paragraph 73); and*
- d. The local planning authority's housing delivery was at least 45% of that required over the previous three years."*

The Revised Framework also sets out how neighbourhood planning gives communities the power to develop a shared vision for their area in order to shape, direct and help deliver sustainable development. However, neighbourhood plans should not promote less development than set out in the strategic policies for the area, or undermine those strategic policies contained in higher order documents.

It is therefore clear from the above that neighbourhood plans should be prepared in conformity with the strategic requirements for the wider area as confirmed in an adopted Development Plan.

The Steering Group should also ensure that its policies and proposals are in compliance with the Neighbourhood Planning Chapter of the Planning Practice Guidance (PPG).

Relationship with Local Plans

To meet the requirements of the Revised Framework and the Neighbourhood Plan Basic Conditions, neighbourhood plans should be prepared to conform to the requirements set out in the adopted Development Plan. Where an up-to-

date Local Plan has been adopted and is in place for the wider authority area, it is the strategic policy requirements set out in this document that a neighbourhood plan should seek to support and meet.

When a Local Plan is emerging, or is yet to be found sound at Examination, there will be a lack of certainty over what scale of development a community must accommodate or the direction the policies in the neighbourhood plan should take. In these instances, the Steering Group should seek to engage with the Local Planning Authority at an early stage in the plan preparation process and request an indicative housing figure which takes into account factors such as the latest evidence of local housing need, the population of the neighbourhood area and the most recently available planning strategy of the local planning authority. Furthermore, policies in the neighbourhood plan should be drafted as flexibly as possible to ensure that they remain effective over the course of the plan period.

Adopted Local Plan

The adopted Development Plan relevant to the preparation of the Bacup and Stacksteads Neighbourhood Plan (BSNP) consists of the Rossendale Core Strategy, adopted in November 2011. The adopted Development Plan is out of date and the Council are progressing a new Local Plan for the borough to meet the requirements of the Framework.

Emerging Local Plan

The Council is currently preparing a new Local Plan for Rossendale, which when adopted will set out the vision, objectives and strategic direction for the borough up to 2034. The emerging Local Plan in accordance with the Local Planning Regulations was submitted to the Secretary of State for examination on the 25th March 2019. The emerging Local Plan considers Bacup a Key Service Centre. This is the highest tier of settlement with a range of housing and employment opportunities. It remains therefore essential that the BSNP is drafted in general conformity with the strategic direction of the emerging Local Plan and the Steering Group will need to ensure there is sufficient flexibility in the policies of the plan to minimise any potential conflicts with the emerging Local Plan upon adoption.

Neighbourhood Plan Policies and Proposals

In accordance with the Neighbourhood Plan Basic Conditions, neighbourhood plan policies should align with the requirements of the Revised Framework and the wider strategic policies for the area set out in the Council's Local Plan. Neighbourhood plans should provide a policy framework that complements and supports the requirements set out in the higher-tier development plan documents, setting out further, locally-specific requirements that will be applied to development proposals coming forward.

The Revised Framework is clear that neighbourhood plans cannot introduce policies and proposals that would prevent sustainable development from going ahead. They are required to plan positively for new development, enabling sufficient growth to take place to assist in meeting the strategic development needs for the area. Policies that are not clearly worded or intended to place an unjustified constraint on further sustainable growth opportunities taking place would not be consistent with the requirements of the Revised Framework or meet the Neighbourhood Plan Basic Conditions.

Communities should not seek to include policies in neighbourhood plans that have no planning basis or are inconsistent with national and local policy obligations. Proposals should be justified by the findings of a supporting evidence base

and must be sufficiently clear to be capable of being interpreted by applications and decision makers. Policies and proposals should be designed to add value to policies set out in Local Plan and national guidance, as opposed to replicating their requirements.

The community should liaise with the Council's planning team and interested parties such as those who have land interests in the neighbourhood area to seek advice on the appropriateness of the neighbourhood plan's proposals.

Strategic Environmental Assessment

The preparation of a neighbourhood plan may fall under the scope of the Environmental Assessment of Plans and Programmes Regulations 2004 (SEA Regulations) that require a Strategic Environmental Assessment (SEA) to be undertaken where a Plan's proposals would be likely to have significant adverse environmental effects. The requirement to undertake an SEA will be dependent on a neighbourhood plan's proposals, but is likely to be necessary where a plan is proposing specific allocations or site designations.

In accordance with Schedule 1 of the SEA Regulations, a Screening Assessment of a neighbourhood plan's proposals should be completed to assess whether an SEA must be prepared. Where an SEA is required this should commence at the earliest opportunity, alongside the preparation of the emerging neighbourhood plan, to ensure the neighbourhood plan's proposals have been properly considered through the SEA process, and appropriately justified against other reasonable alternatives. Where an adequate SEA has not been undertaken a neighbourhood, plan is unlikely to meet the Neighbourhood Plan Basic Conditions.

Although neighbourhood plans do not require a Sustainability Appraisal (SA) of their proposals, preparing an SA can help to show how a neighbourhood plan will contribute to the achievement of sustainable development, a Neighbourhood Plan Basic Condition. Where an SEA is required, extending this assessment to the preparation of an SA is unlikely to require significant additional input.

The Council's planning team will be able to advise on the likely need for an SEA of the neighbourhood plan's proposals. To be compatible with EU obligations, further appraisals, such as a Habitats Regulations Assessment, may also be required depending on local circumstances.

Should you require any further information about the contents of this response or would like to arrange a meeting with a representative from Gladman then please do not hesitate to contact.

Yours faithfully,

A black rectangular box redacting the signature of Andrew Collis.

Andrew Collis
Gladman Developments Ltd.



Homes
England

Rossendale Borough Council
Forward Planning
Room 120
The Business Centre
Bacup
Lancashire
OL13 0BB

24TH February 2020

Dear Sir / Madam,

Consultation on the designation of Bacup and Stackheads Neighbourhood Forum and Neighbourhood Area

Homes England Response

I would firstly like to thank you for the opportunity to comment on the designation of Bacup and Stackheads Neighbourhood Forum and Neighbourhood Area.

Homes England is the government's housing accelerator. We have the appetite, influence, expertise and resources to drive positive market change. By releasing more land to developers who want to make a difference, we're making possible the new homes England needs, helping to improve neighbourhoods and grow communities.

Homes England does not have any land holdings affected by the consultation and therefore we do not propose to make at representations at this point. We will however continue to engage with you as appropriate.

Yours faithfully,

[Redacted Signature]
P.P. Nicola Elsworth
Head of Public Sector Land (North West)
Homes England
[Redacted]

Homes England
1st Floor Churchgate House
56 Oxford Street
Manchester
M1 6EU

[Redacted] 500
www.gov.uk/homes-england



**The Coal
Authority**

Resolving the impacts of mining

Coal Authority
200 Lichfield Lane
Mansfield
Nottinghamshire
NG18 4RG

www.gov.uk/coalauthority

Forward Planning Team
Rossendale Borough Council

BY EMAIL ONLY:

25 February 2020

Dear Sir/Madam

Backup and Stacksteads Neighbourhood Plan – Area Designation

Thank you for the notification of the 14 January 2020 consulting the Coal Authority on the above Neighbourhood Development Plan.

The Coal Authority is a non-departmental public body which works to protect the public and the environment in coal mining areas.

It is noted that this consultation relates to the proposed designation of the Neighbourhood Plan area. Our records indicate that the Neighbourhood Plan area proposed contains legacy from past coal mining activity including; mine entries, coal mine workings at shallow depth and extraction of coal by surface mining methods. Our records also indicate that surface coal resource is present within the area.

Should the future Neighbourhood Plan allocate any sites for development within the designated plan area then consideration would need to be given to the risks posed by past coal mining activity. Where recorded mine entries are identified as being present on a site this may have an impact on the quantum of development which can be accommodated and it is therefore important that consideration is given to such issues as early as possible in the process.

I hope this is helpful but please do not hesitate to contact me should you wish to discuss this further.

Yours faithfully

Melanie Lindsley BA (Hons), DipEH, DipURP, MA, PGCertUD, PGCertSP, MRTPI
Development Team Leader (Planning)

T



Bacup & Stacksteads Neighbourhood Forum Consultation

Response 1

Contact Information and Relationship to Bacup and Stacksteads Neighbourhood Area

Q1. Personal Information** Please note that all personal data will be stored on a database by Rossendale Borough Council. Also, the results of this questionnaire can be made publically available but no contact details will be published.

Title	Ms
First Name(s)	Alex
Last Name	Buchan
House Number/Name	527
Street Name	Helmshore Road
Town	Helmshore
Postcode	BB4 4LQ
Email Address	[REDACTED]
Phone Number	[REDACTED]
Mobile Number	-

Q2. Do you live within Bacup and Stacksteads proposed Neighbourhood Area?

No

Q3. Do you work within Bacup and Stacksteads proposed Neighbourhood Area?

No

Neighbourhood Forum Proposal

Q4. Do you support the designation of a Neighbourhood Forum for Bacup and Stacksteads?

Yes

Q5. Are you happy with the proposed purposes of the Forum?

Yes

Q6. Does the existing Membership of the Forum and the promotion of new members meet the requirements to be representative of the community?

Yes

Q7. Are you happy with the proposed Constitution?

Yes

Neighbourhood Area Proposal

Q8. Do you support the proposed boundaries for the designated area of the Forum?

Yes

Response 2

Contact Information and Relationship to Bacup and Stacksteads Neighbourhood Area

Q1. Personal Information** Please note that all personal data will be stored on a database by Rossendale Borough Council. Also, the results of this questionnaire can be made publically available but no contact details will be published.

Title	-
First Name(s)	Mark
Last Name	McGovern
House Number/Name	SSA Planning
Street Name	PO Box 10201,
Town	Nottingham
Postcode	NG9 9FZ
Email Address	
Phone Number	-
Mobile Number	-

Q2. Do you live within Bacup and Stacksteads proposed Neighbourhood Area?

No

Q3. Do you work within Bacup and Stacksteads proposed Neighbourhood Area?

No

Neighbourhood Forum Proposal

Q4. Do you support the designation of a Neighbourhood Forum for Bacup and Stacksteads?

Yes

Comments:
no comment

Q5. Are you happy with the proposed purposes of the Forum?

Yes

Comments:
no comment

Q6. Does the existing Membership of the Forum and the promotion of new members meet the requirements to be representative of the community?

Yes

Comments:
no comment

Q7. Are you happy with the proposed Constitution?

Yes

Comments:
no comment

Neighbourhood Area Proposal

Q8. Do you support the proposed boundaries for the designated area of the Forum?

Yes

Comments:
no comment

Any further comments?

Q9. Do you have any further comments?

I have no comments to make on the application other than to request (should the application be approved) that I am kept informed of the progress of the Neighbourhood Plan and included in future consultations particularly at Regulation 14, 15 and 16 stage when the policies have been formed.

Response 3

Contact Information and Relationship to Bacup and Stacksteads Neighbourhood Area

Q1. Personal Information** Please note that all personal data will be stored on a database by Rossendale Borough Council. Also, the results of this questionnaire can be made publically available but no contact details will be published.

Title	-
First Name(s)	Phill
Last Name	Rawlins
House Number/Name	2 Spring Bank House
Street Name	Lodge Lane
Town	Bacup
Postcode	OL13 0BJ
Email Address	
Phone Number	-
Mobile Number	-

Q2. Do you live within Bacup and Stacksteads proposed Neighbourhood Area?

Yes

Q3. Do you work within Bacup and Stacksteads proposed Neighbourhood Area?

No

Neighbourhood Forum Proposal

Q4. Do you support the designation of a Neighbourhood Forum for Bacup and Stacksteads?

Yes

Q5. Are you happy with the proposed purposes of the Forum?

Yes

Q6. Does the existing Membership of the Forum and the promotion of new members meet the requirements to be representative of the community?

Yes

Q7. Are you happy with the proposed Constitution?

Yes

Neighbourhood Area Proposal

Q8. Do you support the proposed boundaries for the designated area of the Forum?

Yes

Response 4

Contact Information and Relationship to Bacup and Stacksteads Neighbourhood Area

Q1. Personal Information** Please note that all personal data will be stored on a database by Rossendale Borough Council. Also, the results of this questionnaire can be made publically available but no contact details will be published.

Title	Mrs
First Name(s)	Edith
Last Name	Challinor
House Number/Name	21
Street Name	Sowclough Road
Town	Bacup
Postcode	OL13 8LB
Email Address	[REDACTED]
Phone Number	[REDACTED]
Mobile Number	-

Q2. Do you live within Bacup and Stacksteads proposed Neighbourhood Area?

Yes

Q3. Do you work within Bacup and Stacksteads proposed Neighbourhood Area?

No

Neighbourhood Forum Proposal

Q4. Do you support the designation of a Neighbourhood Forum for Bacup and Stacksteads?

Yes

Comments:

I have put yes but it depends how the Governance is set up and the over sight. We went to the first meeting and heard nothing more from them since then

Q5. Are you happy with the proposed purposes of the Forum?

Yes

Comments:

As above and provided we are kept informed and not ignored like we were the last time.

Q6. Does the existing Membership of the Forum and the promotion of new members meet the requirements to be representative of the community?

Yes

Comments:

Again I have ticked yes but it would be nice if we knew for sure who they were and as I have said not ignored again

Q7. Are you happy with the proposed Constitution?

Yes

Neighbourhood Area Proposal

Q8. Do you support the proposed boundaries for the designated area of the Forum?

Yes

Comments:

Providing that this proposed forum is not just a focus group it needs to look at the whole of the logistics within the proposed boundary and as far as we know the group that you are dealing with as far as we know has only ever had one meeting if they have had more than one we were not asked to attend which we did not like and it shows the Governance is not there

Any further comments?

Q9. Do you have any further comments?

Yes I would say be very careful who you trust because some people have their own agendas. Having lived in Bacup all my life over 75 years I care dearly what happens to Bacup and I am sick of watching it die a slow death being taken over with take aways and barbers, hairdressers and the like Please lets see Bacup thrive again not die

Response 5

Contact Information and Relationship to Bacup and Stacksteads Neighbourhood Area

Q1. Personal Information** Please note that all personal data will be stored on a database by Rossendale Borough Council. Also, the results of this questionnaire can be made publically available but no contact details will be published.

Title	mr
First Name(s)	alan
Last Name	boon
House Number/Name	51
Street Name	pennine rd
Town	bacup
Postcode	ol13 9jp
Email Address	██████████
Phone Number	██████████
Mobile Number	██████████

Q2. Do you live within Bacup and Stacksteads proposed Neighbourhood Area?

Yes

Q3. Do you work within Bacup and Stacksteads proposed Neighbourhood Area?

No

Neighbourhood Forum Proposal

Q4. Do you support the designation of a Neighbourhood Forum for Bacup and Stacksteads?

Yes

Comments:

the people of Bacup need an alternative voice as some councillors prefer not to listen to their constituents

Q5. Are you happy with the proposed purposes of the Forum?

Yes

Q6. Does the existing Membership of the Forum and the promotion of new members meet the requirements to be representative of the community?

Yes

Q7. Are you happy with the proposed Constitution?

Yes

Neighbourhood Area Proposal

Q8. Do you support the proposed boundaries for the designated area of the Forum?

Yes

Response 6

Contact Information and Relationship to Bacup and Stacksteads Neighbourhood Area

Q1. Personal Information** Please note that all personal data will be stored on a database by Rossendale Borough Council. Also, the results of this questionnaire can be made publically available but no contact details will be published.

Title	Mrs
First Name(s)	Janet
Last Name	Boon
House Number/Name	51
Street Name	Pennine Road
Town	Bacup
Postcode	OL13 9JP
Email Address	██████████
Phone Number	██████████
Mobile Number	██████████

Q2. Do you live within Bacup and Stacksteads proposed Neighbourhood Area?

Yes

Q3. Do you work within Bacup and Stacksteads proposed Neighbourhood Area?

No

Neighbourhood Forum Proposal

Q4. Do you support the designation of a Neighbourhood Forum for Bacup and Stacksteads?

Yes

Q5. Are you happy with the proposed purposes of the Forum?

Yes

Q6. Does the existing Membership of the Forum and the promotion of new members meet the requirements to be representative of the community?

Yes

Q7. Are you happy with the proposed Constitution?

Yes

Neighbourhood Area Proposal

Q8. Do you support the proposed boundaries for the designated area of the Forum?

Yes

Response 7

Contact Information and Relationship to Bacup and Stacksteads Neighbourhood Area

Q1. Personal Information** Please note that all personal data will be stored on a database by Rossendale Borough Council. Also, the results of this questionnaire can be made publically available but no contact details will be published.

Title	MS
First Name(s)	EDITH
Last Name	FREEMAN
House Number/Name	15
Street Name	MARK STREET
Town	STACKSTEADS
Postcode	OL13 0LL
Email Address	
Phone Number	-
Mobile Number	-

Q2. Do you live within Bacup and Stacksteads proposed Neighbourhood Area?

Yes

Q3. Do you work within Bacup and Stacksteads proposed Neighbourhood Area?

Yes

Neighbourhood Forum Proposal

Q4. Do you support the designation of a Neighbourhood Forum for Bacup and Stacksteads?

Yes

Q5. Are you happy with the proposed purposes of the Forum?

Yes

Q6. Does the existing Membership of the Forum and the promotion of new members meet the requirements to be representative of the community?

No

Q6. Does the existing Membership of the Forum and the promotion of new members meet the requirements to be representative of the community?

Comments:

Difficult to ascertain from the tables shown. There are 13% where status is undeclared also a postcode is missing and another appears to have been wrongly recorded (OL13 9OA)

Q7. Are you happy with the proposed Constitution?

Yes

Neighbourhood Area Proposal

Q8. Do you support the proposed boundaries for the designated area of the Forum?

Yes

Response 8

Contact Information and Relationship to Bacup and Stacksteads Neighbourhood Area

Q1. Personal Information** Please note that all personal data will be stored on a database by Rossendale Borough Council. Also, the results of this questionnaire can be made publically available but no contact details will be published.

Title	Miss
First Name(s)	Victoria
Last Name	Burnside
House Number/Name	6
Street Name	Haworth drive
Town	Stacksteads
Postcode	OL13 0SA
Email Address	
Phone Number	-
Mobile Number	-

Q2. Do you live within Bacup and Stacksteads proposed Neighbourhood Area?

Yes

Q3. Do you work within Bacup and Stacksteads proposed Neighbourhood Area?

No

Neighbourhood Forum Proposal

Q4. Do you support the designation of a Neighbourhood Forum for Bacup and Stacksteads?

Yes

Comments:

Everyone needs a chance to have their voice heard, their opinions considered and their ideas shared.

Q5. Are you happy with the proposed purposes of the Forum?

Yes

Q6. Does the existing Membership of the Forum and the promotion of new members meet the requirements to be representative of the community?

Yes

Q7. Are you happy with the proposed Constitution?

Yes

Neighbourhood Area Proposal

Q8. Do you support the proposed boundaries for the designated area of the Forum?

Yes

Any further comments?

Q9. Do you have any further comments?

RBC

It is time to allow us to be involved in decision making, planning and give us a greater awareness of the plans that you have initiated.

Let's remove the hierarchy and work together

Response 9

Contact Information and Relationship to Bacup and Stacksteads Neighbourhood Area

Q1. Personal Information** Please note that all personal data will be stored on a database by Rossendale Borough Council. Also, the results of this questionnaire can be made publically available but no contact details will be published.

Title	mrs
First Name(s)	Rachel
Last Name	Shipley
House Number/Name	470
Street Name	Newchurch rd
Town	Bacup
Postcode	OL130NB
Email Address	[REDACTED]
Phone Number	[REDACTED]
Mobile Number	-

Q2. Do you live within Bacup and Stacksteads proposed Neighbourhood Area?

Yes

Q3. Do you work within Bacup and Stacksteads proposed Neighbourhood Area?

No

Neighbourhood Forum Proposal

Q4. Do you support the designation of a Neighbourhood Forum for Bacup and Stacksteads?

Yes

Q5. Are you happy with the proposed purposes of the Forum?

Yes

Q6. Does the existing Membership of the Forum and the promotion of new members meet the requirements to be representative of the community?

Yes

Q7. Are you happy with the proposed Constitution?

Yes

Neighbourhood Area Proposal

Q8. Do you support the proposed boundaries for the designated area of the Forum?

Yes

Response 10

Contact Information and Relationship to Bacup and Stacksteads Neighbourhood Area

Q1. Personal Information** Please note that all personal data will be stored on a database by Rossendale Borough Council. Also, the results of this questionnaire can be made publically available but no contact details will be published.

Title	Mr
First Name(s)	Paul
Last Name	Talbot
House Number/Name	1 Lee View
Street Name	Rochdale Rd
Town	Bacup
Postcode	OL13 9RF
Email Address	
Phone Number	-
Mobile Number	

Q2. Do you live within Bacup and Stacksteads proposed Neighbourhood Area?

Yes

Q3. Do you work within Bacup and Stacksteads proposed Neighbourhood Area?

Yes

Neighbourhood Forum Proposal

Q4. Do you support the designation of a Neighbourhood Forum for Bacup and Stacksteads?

Yes

Q5. Are you happy with the proposed purposes of the Forum?

Yes

Q6. Does the existing Membership of the Forum and the promotion of new members meet the requirements to be representative of the community?

Yes

Q7. Are you happy with the proposed Constitution?

Yes

Neighbourhood Area Proposal

Q8. Do you support the proposed boundaries for the designated area of the Forum?

Yes

Response 11

Contact Information and Relationship to Bacup and Stacksteads Neighbourhood Area

Q1. Personal Information** Please note that all personal data will be stored on a database by Rossendale Borough Council. Also, the results of this questionnaire can be made publically available but no contact details will be published.

Title	-
First Name(s)	vv
Last Name	vv
House Number/Name	vv
Street Name	vv
Town	vv
Postcode	vv
Email Address	vv
Phone Number	vv
Mobile Number	v

Q2. Do you live within Bacup and Stacksteads proposed Neighbourhood Area?

No

Q3. Do you work within Bacup and Stacksteads proposed Neighbourhood Area?

Yes

Neighbourhood Forum Proposal

Q4. Do you support the designation of a Neighbourhood Forum for Bacup and Stacksteads?

No

Q5. Are you happy with the proposed purposes of the Forum?

No

Q6. Does the existing Membership of the Forum and the promotion of new members meet the requirements to be representative of the community?

No

Q7. Are you happy with the proposed Constitution?

No

Neighbourhood Area Proposal

Q8. Do you support the proposed boundaries for the designated area of the Forum?

No

Any further comments?

Q9. Do you have any further comments?

vv

Response 12

Contact Information and Relationship to Bacup and Stacksteads Neighbourhood Area

Q1. Personal Information** Please note that all personal data will be stored on a database by Rossendale Borough Council. Also, the results of this questionnaire can be made publically available but no contact details will be published.

Title	Mr
First Name(s)	Stephen
Last Name	Anderson
House Number/Name	7
Street Name	Bankside Close
Town	Bacup
Postcode	OL138HZ
Email Address	
Phone Number	-
Mobile Number	-

Q2. Do you live within Bacup and Stacksteads proposed Neighbourhood Area?

Yes

Q3. Do you work within Bacup and Stacksteads proposed Neighbourhood Area?

No

Neighbourhood Forum Proposal

Q4. Do you support the designation of a Neighbourhood Forum for Bacup and Stacksteads?

Yes

Q5. Are you happy with the proposed purposes of the Forum?

Yes

Q6. Does the existing Membership of the Forum and the promotion of new members meet the requirements to be representative of the community?

Yes

Q7. Are you happy with the proposed Constitution?

Yes

Neighbourhood Area Proposal

Q8. Do you support the proposed boundaries for the designated area of the Forum?

Yes

Response 13

Contact Information and Relationship to Bacup and Stacksteads Neighbourhood Area

Q1. Personal Information** Please note that all personal data will be stored on a database by Rossendale Borough Council. Also, the results of this questionnaire can be made publically available but no contact details will be published.

Title	-
First Name(s)	Jennifer
Last Name	Rawlins
House Number/Name	2 Spring Bank House
Street Name	Lodge Lane
Town	Bacup
Postcode	OL13 0BJ
Email Address	[REDACTED]
Phone Number	-
Mobile Number	-

Q2. Do you live within Bacup and Stacksteads proposed Neighbourhood Area?

Yes

Q3. Do you work within Bacup and Stacksteads proposed Neighbourhood Area?

Yes

Neighbourhood Forum Proposal

Q4. Do you support the designation of a Neighbourhood Forum for Bacup and Stacksteads?

Yes

Q5. Are you happy with the proposed purposes of the Forum?

Yes

Q6. Does the existing Membership of the Forum and the promotion of new members meet the requirements to be representative of the community?

Yes

Q7. Are you happy with the proposed Constitution?

Yes

Neighbourhood Area Proposal

Q8. Do you support the proposed boundaries for the designated area of the Forum?

Yes

Any further comments?

Q9. Do you have any further comments?

Very happy with the proposal, forum and area.

Response 14

Contact Information and Relationship to Bacup and Stacksteads Neighbourhood Area

Q1. Personal Information** Please note that all personal data will be stored on a database by Rossendale Borough Council. Also, the results of this questionnaire can be made publically available but no contact details will be published.

Title	Mrs
First Name(s)	Nicola
Last Name	Longmire
House Number/Name	34
Street Name	Booth road stacksteads
Town	Bacup lancs
Postcode	OL130SF
Email Address	[REDACTED]
Phone Number	[REDACTED]
Mobile Number	-

Q2. Do you live within Bacup and Stacksteads proposed Neighbourhood Area?

Yes

Q3. Do you work within Bacup and Stacksteads proposed Neighbourhood Area?

No

Neighbourhood Forum Proposal

Q4. Do you support the designation of a Neighbourhood Forum for Bacup and Stacksteads?

Yes

Comments:

Think is is a great idea so that the local residents can have their views heard by the local council .

Q5. Are you happy with the proposed purposes of the Forum?

Yes

Comments:

Yes this group is run by very good and knowledgeable local residents .

Q6. Does the existing Membership of the Forum and the promotion of new members meet the requirements to be representative of the community?

Yes

Comments:

Yes only local people can join it

Q7. Are you happy with the proposed Constitution?

Yes

Neighbourhood Area Proposal

Q8. Do you support the proposed boundaries for the designated area of the Forum?

Yes

Comments:

Yes so that only local residents that issue will effect can join it

Any further comments?

Q9. Do you have any further comments?

I think that this is a great idea so that local residents can work along with the council to improve the area for the better for us all .

Response 15

Contact Information and Relationship to Bacup and Stacksteads Neighbourhood Area

Q1. Personal Information** Please note that all personal data will be stored on a database by Rossendale Borough Council. Also, the results of this questionnaire can be made publically available but no contact details will be published.

Title	Mr
First Name(s)	Duncan
Last Name	Middlebrook
House Number/Name	22
Street Name	Peel drive
Town	Bacup
Postcode	OL139pu
Email Address	[REDACTED]
Phone Number	[REDACTED]
Mobile Number	-

Q2. Do you live within Bacup and Stacksteads proposed Neighbourhood Area?

Yes

Q3. Do you work within Bacup and Stacksteads proposed Neighbourhood Area?

Yes

Neighbourhood Forum Proposal

Q4. Do you support the designation of a Neighbourhood Forum for Bacup and Stacksteads?

Yes

Q5. Are you happy with the proposed purposes of the Forum?

Yes

Q6. Does the existing Membership of the Forum and the promotion of new members meet the requirements to be representative of the community?

Yes

Q7. Are you happy with the proposed Constitution?

Yes

Neighbourhood Area Proposal

Q8. Do you support the proposed boundaries for the designated area of the Forum?

Yes

Response 16

Contact Information and Relationship to Bacup and Stacksteads Neighbourhood Area

Q1. Personal Information** Please note that all personal data will be stored on a database by Rossendale Borough Council. Also, the results of this questionnaire can be made publically available but no contact details will be published.

Title	Mrs
First Name(s)	Karen
Last Name	Dodson
House Number/Name	1
Street Name	Change Close
Town	Bacup
Postcode	OL13 9HX
Email Address	
Phone Number	-
Mobile Number	-

Q2. Do you live within Bacup and Stacksteads proposed Neighbourhood Area?

Yes

Q3. Do you work within Bacup and Stacksteads proposed Neighbourhood Area?

No

Neighbourhood Forum Proposal

Q4. Do you support the designation of a Neighbourhood Forum for Bacup and Stacksteads?

Yes

Q5. Are you happy with the proposed purposes of the Forum?

Yes

Q6. Does the existing Membership of the Forum and the promotion of new members meet the requirements to be representative of the community?

Yes

Q7. Are you happy with the proposed Constitution?

Yes

Neighbourhood Area Proposal

Q8. Do you support the proposed boundaries for the designated area of the Forum?

Yes

Response 17

Contact Information and Relationship to Bacup and Stacksteads Neighbourhood Area

Q1. Personal Information** Please note that all personal data will be stored on a database by Rossendale Borough Council. Also, the results of this questionnaire can be made publically available but no contact details will be published.

Title	Mrs
First Name(s)	Anita
Last Name	Heyworth
House Number/Name	21
Street Name	Stanley Street
Town	Bacup
Postcode	OL138DN
Email Address	
Phone Number	-
Mobile Number	-

Q2. Do you live within Bacup and Stacksteads proposed Neighbourhood Area?

Yes

Q3. Do you work within Bacup and Stacksteads proposed Neighbourhood Area?

No

Neighbourhood Forum Proposal

Q4. Do you support the designation of a Neighbourhood Forum for Bacup and Stacksteads?

Yes

Q5. Are you happy with the proposed purposes of the Forum?

Yes

Q6. Does the existing Membership of the Forum and the promotion of new members meet the requirements to be representative of the community?

Yes

Q7. Are you happy with the proposed Constitution?

Yes

Neighbourhood Area Proposal

Q8. Do you support the proposed boundaries for the designated area of the Forum?

Yes

Response 18

Contact Information and Relationship to Bacup and Stacksteads Neighbourhood Area

Q1. Personal Information** Please note that all personal data will be stored on a database by Rossendale Borough Council. Also, the results of this questionnaire can be made publically available but no contact details will be published.

Title	Miss
First Name(s)	Elizabeth
Last Name	Wright
House Number/Name	2
Street Name	Darley Bank
Town	Bacup
Postcode	OL13 9SP
Email Address	[REDACTED]
Phone Number	[REDACTED]
Mobile Number	[REDACTED]

Q2. Do you live within Bacup and Stacksteads proposed Neighbourhood Area?

Yes

Q3. Do you work within Bacup and Stacksteads proposed Neighbourhood Area?

No

Neighbourhood Forum Proposal

Q4. Do you support the designation of a Neighbourhood Forum for Bacup and Stacksteads?

Yes

Q5. Are you happy with the proposed purposes of the Forum?

Yes

Q6. Does the existing Membership of the Forum and the promotion of new members meet the requirements to be representative of the community?

Yes

Q7. Are you happy with the proposed Constitution?

Yes

Neighbourhood Area Proposal

Q8. Do you support the proposed boundaries for the designated area of the Forum?

Yes

Response 19

Contact Information and Relationship to Bacup and Stacksteads Neighbourhood Area

Q1. Personal Information** Please note that all personal data will be stored on a database by Rossendale Borough Council. Also, the results of this questionnaire can be made publically available but no contact details will be published.

Title	Mrs
First Name(s)	Andrea
Last Name	Harwood
House Number/Name	1
Street Name	Cutler greens
Town	Stacksteads
Postcode	OL130hz
Email Address	██████████
Phone Number	██████████
Mobile Number	██████████

Q2. Do you live within Bacup and Stacksteads proposed Neighbourhood Area?

Yes

Q3. Do you work within Bacup and Stacksteads proposed Neighbourhood Area?

No

Neighbourhood Forum Proposal

Q4. Do you support the designation of a Neighbourhood Forum for Bacup and Stacksteads?

Yes

Q5. Are you happy with the proposed purposes of the Forum?

Yes

Q6. Does the existing Membership of the Forum and the promotion of new members meet the requirements to be representative of the community?

No

Q6. Does the existing Membership of the Forum and the promotion of new members meet the requirements to be representative of the community?

Comments:

Don't know

Q7. Are you happy with the proposed Constitution?

No

Comments:

Don't know

Neighbourhood Area Proposal

Q8. Do you support the proposed boundaries for the designated area of the Forum?

Yes

Response 20

Contact Information and Relationship to Bacup and Stacksteads Neighbourhood Area

Q1. Personal Information** Please note that all personal data will be stored on a database by Rossendale Borough Council. Also, the results of this questionnaire can be made publically available but no contact details will be published.

Title	Mr
First Name(s)	Ian
Last Name	Francis
House Number/Name	39
Street Name	Windermere Road
Town	Bacup
Postcode	OL13 9DN
Email Address	
Phone Number	-
Mobile Number	

Q2. Do you live within Bacup and Stacksteads proposed Neighbourhood Area?

Yes

Q3. Do you work within Bacup and Stacksteads proposed Neighbourhood Area?

No

Neighbourhood Forum Proposal

Q4. Do you support the designation of a Neighbourhood Forum for Bacup and Stacksteads?

Yes

Q5. Are you happy with the proposed purposes of the Forum?

Yes

Comments:

Yes. I consider that despite the efforts of the Rossendale District Council the local general community was not fully aware of or educated about the District Development Plan that was recently reviewed by the Planning Inspectorate.

Q6. Does the existing Membership of the Forum and the promotion of new members meet the requirements to be representative of the community?

Yes

Comments:

The constitution makes it clear that all parts of the community can be involved, including businesses, the RBC and LCC on an advisory, consultative and feedback basis, so there will be no part of the community that will be unable to be involved. No qualifying individual is excluded from becoming a member of the forum.

Q7. Are you happy with the proposed Constitution?

Yes

Comments:

At this stage yes, but it may be amended, as stated, in the light of developments or advice.

Neighbourhood Area Proposal

Q8. Do you support the proposed boundaries for the designated area of the Forum?

Yes

Comments:

The proposed boundaries take in all parts of the Bacup and Stacksteads area.

Any further comments?

Q9. Do you have any further comments?

The involvement of independent, capable citizens in the future development of the local area plan is critical and helps to act as an innovative and overseeing entity for local governmental organisations, thereby ensuring that planning is more fully responsive to local residents' needs, wishes and concerns.

Response 21

Contact Information and Relationship to Bacup and Stacksteads Neighbourhood Area

Q1. Personal Information** Please note that all personal data will be stored on a database by Rossendale Borough Council. Also, the results of this questionnaire can be made publically available but no contact details will be published.

Title	Mrs
First Name(s)	Jennie
Last Name	Rawlins
House Number/Name	2 springbank house
Street Name	Lodge lane
Town	Bacup
Postcode	OL13 0BJ
Email Address	
Phone Number	-
Mobile Number	-

Q2. Do you live within Bacup and Stacksteads proposed Neighbourhood Area?

Yes

Q3. Do you work within Bacup and Stacksteads proposed Neighbourhood Area?

Yes

Neighbourhood Forum Proposal

Q4. Do you support the designation of a Neighbourhood Forum for Bacup and Stacksteads?

Yes

Q5. Are you happy with the proposed purposes of the Forum?

Yes

Q6. Does the existing Membership of the Forum and the promotion of new members meet the requirements to be representative of the community?

Yes

Q7. Are you happy with the proposed Constitution?

Yes

Neighbourhood Area Proposal

Q8. Do you support the proposed boundaries for the designated area of the Forum?

Yes

Response 22

Contact Information and Relationship to Bacup and Stacksteads Neighbourhood Area

Q1. Personal Information** Please note that all personal data will be stored on a database by Rossendale Borough Council. Also, the results of this questionnaire can be made publically available but no contact details will be published.

Title	Mr
First Name(s)	Daniel
Last Name	Dawkins
House Number/Name	26
Street Name	Goldcrest Ave
Town	Bacup
Postcode	OL139PA
Email Address	
Phone Number	-
Mobile Number	-

Q2. Do you live within Bacup and Stacksteads proposed Neighbourhood Area?

Yes

Q3. Do you work within Bacup and Stacksteads proposed Neighbourhood Area?

No

Neighbourhood Forum Proposal

Q4. Do you support the designation of a Neighbourhood Forum for Bacup and Stacksteads?

Yes

Q5. Are you happy with the proposed purposes of the Forum?

Yes

Q6. Does the existing Membership of the Forum and the promotion of new members meet the requirements to be representative of the community?

Yes

Q7. Are you happy with the proposed Constitution?

Yes

Neighbourhood Area Proposal

Q8. Do you support the proposed boundaries for the designated area of the Forum?

Yes

Response 23

Contact Information and Relationship to Bacup and Stacksteads Neighbourhood Area

Q1. Personal Information** Please note that all personal data will be stored on a database by Rossendale Borough Council. Also, the results of this questionnaire can be made publically available but no contact details will be published.

Title	Mrs
First Name(s)	Sandra
Last Name	Harrow
House Number/Name	165
Street Name	Rochdale Road
Town	Bacup
Postcode	OL13 9NS
Email Address	████████████████████
Phone Number	██████████
Mobile Number	██████████

Q2. Do you live within Bacup and Stacksteads proposed Neighbourhood Area?

Yes

Q3. Do you work within Bacup and Stacksteads proposed Neighbourhood Area?

No

Neighbourhood Forum Proposal

Q4. Do you support the designation of a Neighbourhood Forum for Bacup and Stacksteads?

Yes

Comments:

Although more publicity of this forum - ie: a (random) mailshot - would have given a fairer representation across the community - I happened to stumble across this on Facebook!

Q5. Are you happy with the proposed purposes of the Forum?

Yes

Q6. Does the existing Membership of the Forum and the promotion of new members meet the requirements to be representative of the community?

Yes

Comments:

Although I have no idea who the existing members are.
Promotion of new members is a good idea.

Q7. Are you happy with the proposed Constitution?

Yes

Comments:

But are 21 members enough - and should these be independent from the councillors ?

Neighbourhood Area Proposal

Q8. Do you support the proposed boundaries for the designated area of the Forum?

No

Comments:

No - If its "Bacup & Stacksteads" then Weir should be included

Any further comments?

Q9. Do you have any further comments?

I received this at short notice - ie: with 4 days to go - I doubt you will get a response truly representative of your population if surveys are only sent by this method.

I appreciate paper surveys are expensive, but true "public consultation" should be just that.

Response 24

Contact Information and Relationship to Bacup and Stacksteads Neighbourhood Area

Q1. Personal Information** Please note that all personal data will be stored on a database by Rossendale Borough Council. Also, the results of this questionnaire can be made publically available but no contact details will be published.

Title	Mr
First Name(s)	Gary
Last Name	Catlow
House Number/Name	292
Street Name	Newchurch road
Town	Bacup
Postcode	OL13 0uj
Email Address	[REDACTED]
Phone Number	-
Mobile Number	[REDACTED]

Q2. Do you live within Bacup and Stacksteads proposed Neighbourhood Area?

Yes

Q3. Do you work within Bacup and Stacksteads proposed Neighbourhood Area?

No

Neighbourhood Forum Proposal

Q4. Do you support the designation of a Neighbourhood Forum for Bacup and Stacksteads?

Yes

Q5. Are you happy with the proposed purposes of the Forum?

Yes

Q6. Does the existing Membership of the Forum and the promotion of new members meet the requirements to be representative of the community?

Yes

Q7. Are you happy with the proposed Constitution?

Yes

Neighbourhood Area Proposal

Q8. Do you support the proposed boundaries for the designated area of the Forum?

Yes

Response 25

Contact Information and Relationship to Bacup and Stacksteads Neighbourhood Area

Q1. Personal Information** Please note that all personal data will be stored on a database by Rossendale Borough Council. Also, the results of this questionnaire can be made publically available but no contact details will be published.

Title	Mrs
First Name(s)	June
Last Name	Griffin
House Number/Name	7
Street Name	Glenborough ave
Town	Bacup
Postcode	OL13 0st
Email Address	[REDACTED]
Phone Number	[REDACTED]
Mobile Number	-

Q2. Do you live within Bacup and Stacksteads proposed Neighbourhood Area?

Yes

Q3. Do you work within Bacup and Stacksteads proposed Neighbourhood Area?

No

Neighbourhood Forum Proposal

Q4. Do you support the designation of a Neighbourhood Forum for Bacup and Stacksteads?

Yes

Q5. Are you happy with the proposed purposes of the Forum?

Yes

Q6. Does the existing Membership of the Forum and the promotion of new members meet the requirements to be representative of the community?

Yes

Q7. Are you happy with the proposed Constitution?

Yes

Neighbourhood Area Proposal

Q8. Do you support the proposed boundaries for the designated area of the Forum?

Yes

Response 26

Contact Information and Relationship to Bacup and Stacksteads Neighbourhood Area

Q1. Personal Information** Please note that all personal data will be stored on a database by Rossendale Borough Council. Also, the results of this questionnaire can be made publically available but no contact details will be published.

Title	Mr
First Name(s)	Keith
Last Name	Loughlin
House Number/Name	38
Street Name	Brandwood Road,
Town	Bacup
Postcode	OL13 0NU
Email Address	[REDACTED]
Phone Number	[REDACTED]
Mobile Number	[REDACTED]

Q2. Do you live within Bacup and Stacksteads proposed Neighbourhood Area?

Yes

Q3. Do you work within Bacup and Stacksteads proposed Neighbourhood Area?

No

Neighbourhood Forum Proposal

Q4. Do you support the designation of a Neighbourhood Forum for Bacup and Stacksteads?

Yes

Comments:

Having spoken to main lead of the Forum, whilst there is a vast amount of work to be undertaken to produce relevant documentation, I feel there is a strong will to succeed with a good mix of support members to finalise a workable document.

Q5. Are you happy with the proposed purposes of the Forum?

Yes

Comments:

Good vision engendered, given of ultimate aim of Forum.

Q6. Does the existing Membership of the Forum and the promotion of new members meet the requirements to be representative of the community?

Yes

Comments:

Whilst the area covered by the Forum is geographically large the vision of the group seems to indicate an understanding of the tasks ahead and a drive to achieve a workable document, linked to current RBC draft Local Plan requirements. There is also an understanding of the need to engage with the wider community and current organisations within the valley.

Q7. Are you happy with the proposed Constitution?

Yes

Comments:

The draft constitution presents an initial working outline, which no doubt will need to change to meet the challenges of the Forum

Neighbourhood Area Proposal

Q8. Do you support the proposed boundaries for the designated area of the Forum?

Yes

Comments:

Albeit a large geographical area of the Borough there is a large rural part to the communities and no doubt the scope of the boundaries can be adjusted in the future if required.

Any further comments?

Q9. Do you have any further comments?

This Forum should aim to be part of a "hub and spoke" organisation, linking with other existing community groups and valley organisations, to pull together an approach which could benefit future developments in Bacup and Stacksteads, thus reflecting real community needs and views.

Response 27

Contact Information and Relationship to Bacup and Stacksteads Neighbourhood Area

Q1. Personal Information** Please note that all personal data will be stored on a database by Rossendale Borough Council. Also, the results of this questionnaire can be made publically available but no contact details will be published.

Title	Mr
First Name(s)	Robert
Last Name	Wells
House Number/Name	2
Street Name	Brambling Drive
Town	Bacup
Postcode	OL13 9QJ
Email Address	[REDACTED]
Phone Number	[REDACTED]
Mobile Number	[REDACTED]

Q2. Do you live within Bacup and Stacksteads proposed Neighbourhood Area?

Yes

Q3. Do you work within Bacup and Stacksteads proposed Neighbourhood Area?

Yes

Neighbourhood Forum Proposal

Q4. Do you support the designation of a Neighbourhood Forum for Bacup and Stacksteads?

Yes

Comments:

I believe this would be good for the area and help to re-engage the community with having a say in guiding development in the local area.

Q5. Are you happy with the proposed purposes of the Forum?

Yes

Q6. Does the existing Membership of the Forum and the promotion of new members meet the requirements to be representative of the community?

Yes

Q7. Are you happy with the proposed Constitution?

Yes

Neighbourhood Area Proposal

Q8. Do you support the proposed boundaries for the designated area of the Forum?

Yes

Any further comments?

Q9. Do you have any further comments?

If formed, I think the neighbourhood forum will be a useful tool for the council to better engage with residents about planning issues.

Response 28

Contact Information and Relationship to Bacup and Stacksteads Neighbourhood Area

Q1. Personal Information** Please note that all personal data will be stored on a database by Rossendale Borough Council. Also, the results of this questionnaire can be made publically available but no contact details will be published.

Title	Mrs
First Name(s)	Janet
Last Name	Boon
House Number/Name	51
Street Name	Pennine Road
Town	Bacup
Postcode	OL13 9JP
Email Address	██████████
Phone Number	██████████
Mobile Number	██████████

Q2. Do you live within Bacup and Stacksteads proposed Neighbourhood Area?

Yes

Q3. Do you work within Bacup and Stacksteads proposed Neighbourhood Area?

Yes

Neighbourhood Forum Proposal

Q4. Do you support the designation of a Neighbourhood Forum for Bacup and Stacksteads?

Yes

Comments:

Absolutely. We the residents want to be involved in the progression of our town. We want to have our say and input and be listened to.

Q5. Are you happy with the proposed purposes of the Forum?

Yes

Comments:

Yes

Q6. Does the existing Membership of the Forum and the promotion of new members meet the requirements to be representative of the community?

Yes

Q7. Are you happy with the proposed Constitution?

Yes

Neighbourhood Area Proposal

Q8. Do you support the proposed boundaries for the designated area of the Forum?

Yes

Any further comments?

Q9. Do you have any further comments?

Proposed building development should be brought before the neighbourhood committee for consultation. It is imperative that people are listened to and their concerns raised, alleviated or dealt with in an appropriate manner. This can only be achieved by open discussion and debate.